



Azure Moulded 122cm (48")

- 3 SPEED WALL CONTROL
- REMOTE ADAPTABLE
- REVERSIBLE
- 10° BLADE PITCH
- 7 YEAR WARRANTY



A223

MATT WHITE

With matt white moulded blades
122cm (48")

^ Hunter Pacific International Pty Ltd reserves the right to change specifications without notice.
Colours shown may vary from actual product. Refer to website for full terms and conditions.

Azure Moulded 122cm (48")

Product Range:

A223 - Matt White with Matt White Blades

Features:

- 3 Speed wall control
- Summer/Winter reversible via switch on motor
- Moulded plastic blades
- Remote Adaptable
- Suitable for flat & pitched ceilings up to 28°
- 7 Year warranty^

Installation Locations:

Indoor installation only.

There should be at least 2.1m between the lowest point of the fan blades and the floor.

Wall Control Speed Capacitor Values:

2µF & 3.5µF

Warranty:

- 3 year in-home warranty on the motor, excluding cosmetic issues and corrosion (unless reported in the first 3 months).
- 4 year additional Parts Only Warranty on the motor.
- All non-integrated HPI light kits and AC remote control systems are separately purchased accessories for AC ceiling fans, and as such are covered by our accessory parts warranty.
- 1 year warranty applies when the fan or relevant part is used in any non-domestic applications.

*For full warranty details please see Hunter Pacific International's website www.hunterpacific.com.au

Accessories (Supplied separately):

Down Rod 21mm diameter (includes wire loom)

- 050 - 910mm White Downrod
- 060 - 180cm White Downrod

009 - T-Hook for ceiling roses

AC Remote Control Units

- A2002 - Konetik (3 speed - non dimming AC remote)
- A2003 - Logic (4 speed - dimming, timer function, AC remote)

Zellweger Ripple Tone Filter Unit

- 007 - 1050Hz Notch Filter Noise Suppressor
- 008 - 750Hz Notch Filter Noise Suppressor

- W06-015 Capacitor 2 & 3.5uF
- W06-018 Wall Mech & Knob Only
- W06-020 Start Run Cap 1.5uF
- W06-026 Wall Mech & Capacitor 2 & 3.5uF

Extra Information:

Motor: 153mm x 15mm motor 16 Pole, Made with the highest grade copper windings and silicone steel stator. Bearings are sealed to ensure quiet operation and long life.

Blades: 122cm (48") Straight Style
Materials: Moulded plastic
Blade Pitch: 10°

Weight Including Packaging:

Complete fan: 6.4kg

Packaging Dimensions (cm):

54L x 24W x 26H

	Low	Medium	High
RPMS	102	145	182
WATTS	15.6	26.9	47.2
AIRFLOW: CMH*	6459	8637	11542

* CMH = Cubic Meters per Hour

DIMENSIONS

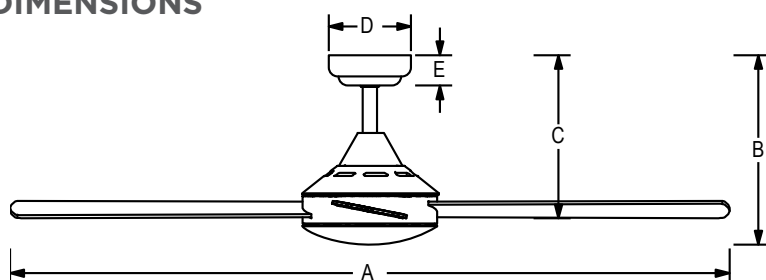

A	1220mm
B	340mm
C	290mm
D	131mm
E	56mm